



 clesana™

No water. No chemicals.  
No separation toilet.

Medical precision in caravanning.

Clesana C1  
The Welding-Toilet.

## Clesana C1

# The innovation in the field of mobile sanitary solutions: flexible, reliable and environmentally friendly.

With the Clesana C1, we deliberately departed from established paths in the domain of mobile sanitation solutions and introduced a **unique welding process**.

In this method, all waste materials are **automatically sealed in individual bags** in accordance with medical hygiene standards and collected in a space-saving manner.

The Clesana C1 requires no sanitary additives, no water, is **odor-tight** thanks to barrier foil liners, **hygienic and can be disposed of with household and residual waste**.

The Clesana C1 shares a **compatible footprint with most conventional cassette toilets** making it **easy to retrofit with minimal effort**.

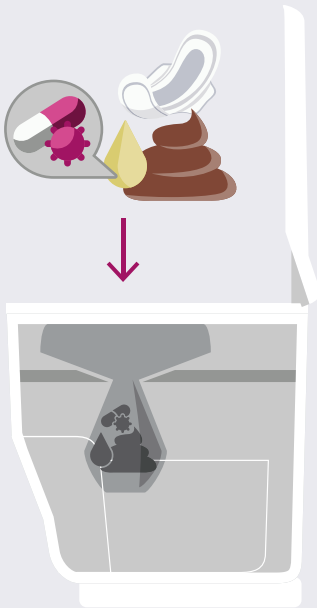

# What changes with the Clesana C1?

## Your key benefits at a glance

Always clean and absolutely hygienic.

No odors thanks to the barrier foil liner.

Easy and secure disposal.

Enhanced independence and flexibility.

Universally applicable - disposal of hygienic items, food remnants, wet wipes, etc.

No preparation required. Ready for use immediately.

Never clean the toilet bowl again.

Low maintenance - no water, no winterization, no additives.

Environmentally friendly.



Clesana C1 with round socket for flexible room placement.



## Environmental footprint **Systematically eco-friendly.**

### **Environmentally friendly despite foil? How can that be?**

The Clesana C1 in comparison to a green sanitation additive:

---

Requires fewer resources (water), thus reducing the strain on ecosystems.

---

Minimizes negative impacts on water quality.

---

Helps prevent soil acidification.

---

Has a smaller CO<sub>2</sub> footprint by over 10%.

---

Safeguards health with an infection barrier.

---

Eliminates the need for sanitation additives, care products, and special toilet paper.

---

### **CO<sub>2</sub> balance - calculation example:**

A 1,5 km drive is equivalent to the CO<sub>2</sub> emissions of 6 bags (Ø average daily amount for adults). A 15 km detour to a disposal station corresponds to 60 bags.

With the Clesana C1, there's no need for detours and you can stay off-grid without limits. By utilizing barrier foil, significant CO<sub>2</sub> savings are achieved elsewhere.

# Clesana C1

## Excellently designed. Easy to use.

### Technical specifications

Nominal voltage	12 V
Supply voltage	11,8 - 15 V
Max. Power consumption (shortterm)	22 A
Power consumption standby mode	0,28 W
Energy consumption welding process	0,55 Wh
Energy consumption separation process	1,7 Wh

### Calculation example:

From a 10 Ah capacity lithium-battery you can effortlessly weld 70 individual bags.

The Clesana C1 shares a **1:1 compatibility in terms of its dimensions with the Thetford C260 & C220 series** and also for other toilet systems it can be retrofitted **with minimal effort by specialized dealers.**



Clesana C1 with L-adaptor for modulare conversion based on the C220 & C260 series.



Intuitive control panel with informative display, matching C260 series dimensions.

### Consumables

Barrier foil liner (content: 2 packs)

for Ø 80 bags

Clean. Care. Comfort.



**[clesana.com](http://clesana.com)**

To find retailers, visit [clesana.com](http://clesana.com) or:

